

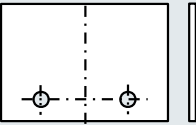

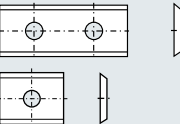



EN TIGRALLOY products
DE TIGRALLOY Produkte
FR Produits TIGRALLOY
IT Prodotti TIGRALLOY
ES Productos TIGRALLOY

EN TIGRALLOY products
 DE TIGRALLOY Produkte
 FR Produits TIGRALLOY
 IT Prodotti TIGRALLOY
 ES Productos TIGRALLOY

	<p> EN TIGRALLOY - Saw tips DE TIGRALLOY - Sägezähne FR TIGRALLOY - Dents de scie IT TIGRALLOY - Dentelli per lame ES TIGRALLOY - Dientes de sierra </p>	<p style="text-align: right;">166 - 168</p>
	<p> EN TIGRALLOY - Blanks for profiling DE TIGRALLOY - Blanketts zum Profilieren FR TIGRALLOY - Plaquettes à profiler IT TIGRALLOY - Placchette da profilare ES TIGRALLOY - Placas para perfilar </p>	<p style="text-align: right;">169 - 171</p>
	<p> EN TIGRALLOY - Reversible knives DE TIGRALLOY - Wendeschneidplatten FR TIGRALLOY - Plaquettes réversibles IT TIGRALLOY - Coltelli reversibili ES TIGRALLOY - Cuchillas reversibles </p>	<p style="text-align: right;">172 - 173</p>
	<p> EN TIGRALLOY - Strips and preformed tips for brazed cutters DE TIGRALLOY - Fräserplatten und Formplatten zum Lötén FR TIGRALLOY - Plaquettes à braser IT TIGRALLOY - Placchette per frese saldobrasate ES TIGRALLOY - Placas para equipar fresas y herramientas soldadas </p>	<p style="text-align: right;">174 - 175</p>
	<p> EN TIGRALLOY - Planer knives DE TIGRALLOY - Hobelmesser FR TIGRALLOY - Couteaux à raboter IT TIGRALLOY - Coltelli da pialla ES TIGRALLOY - Cuchillas para cepillar </p>	<p style="text-align: right;">176</p>
	<p> EN TIGRALLOY - Planer knives for system Centrolock DE TIGRALLOY - Hobelmesser für System Centrolock FR TIGRALLOY - Couteaux à raboter pour système Centrolock IT TIGRALLOY - Coltelli da pialla per sistema Centrolock ES TIGRALLOY - Cuchillas para cepillar para sistema Centrolock </p>	<p style="text-align: right;">177</p>
	<p> EN TIGRALLOY - SuperPac DE TIGRALLOY - SuperPac FR TIGRALLOY - SuperPac IT TIGRALLOY - SuperPac ES TIGRALLOY - SuperPac </p>	<p style="text-align: right;">178 - 179</p>

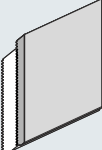
EN TECHNICAL DATA AND APPLICATION RECOMMENDATIONS

(for more information please see our TIGRALLOY brochure and our technical guidebook "Carbide for cutting tools")

TIGRALLOY, an alloy which mainly consists of cobalt, chromium and tungsten, takes a special position within the cutting materials being neither tungsten carbide nor HSS.

Even though its hardness is rather low, TIGRALLOY can achieve multiple lifetimes of tungsten carbide in many applications because its wear pattern is completely different. In addition, TIGRALLOY is extremely corrosion resistant, tough and heat resistant up to around 800°C / 1500°F. The high bending strength and material composition allow steep angles and very sharp cutting edges which reduces cutting pressure and can achieve excellent surface qualities. TIGRALLOY is made by powder metallurgy and thus, compared to similar, cast materials 100% void-free.

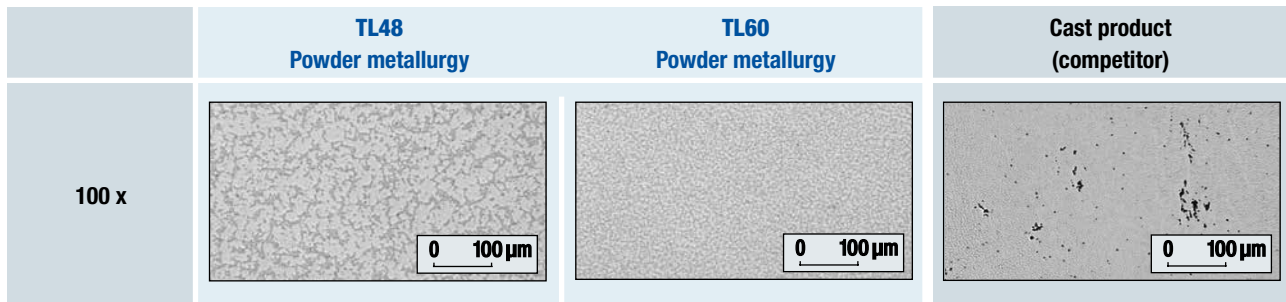

Fig. 1: Homogeneous, void-free TIGRALLOY made by powder metallurgy compared to a similarly alloyed but cast product.

2 grades are offered:

TL48 (hardness 48 HRC), especially as saw tips for processing green lumber. Here, the high toughness is used to make TL48 the ideal cutting material for circular, band- and gangsaws for the saw mill industry. Available in shapes of triangles, rectangles and typical saw tip shapes.

TL60 (hardness 60 HRC) for indexable inserts, blanks for profiling, planer knives, back corrugated knives and STBs for brazed tools: perfect surface qualities and excellent lifetime in the described types of wood (without gluelines), compare to Fig. 2. In addition, weight of the blades is reduced by around 40%.

TIGRALLOY provides decisive advantages in most solid woods:

- **Tool life:** in many types of wood tool life is increased substantially compared to tungsten carbide, especially in hardwoods.
- Excellent **surface quality:** The high bending strength and the composition of the material allow very sharp cutting edges, which reduce the cutting pressure.
- Increased **productivity** as TIGRALLOY makes possible to run in greater feed rates and revolution speeds.
- **Secure processing:** TIGRALLOY is required to 100% free of macropores, thus no multiple production due to porosity.

TL48 - for circular saw blades and band saws

recommended:

nearly all kinds of raw woods, frozen wood
recycling of wood with impurities (e.g. pellets)

not recommended:

board materials, glued-up wood
extremely abrasive or resinified woods

TL60 - for planers, indexable inserts and brazed profiling tools

recommended:

Abachi	Incense cedar	Pine
Afromosia	Larch	Plane
Afzelia (min. 12% humidity)	Limba	Poplar
Alder	Mahogany (American red)	Ramin
Ash	Makoré	Redwood
Avodiré	Maple (European)	Sapele
Beech (min. 12% humidity)	Mengkulang	Sipo
Birch (European)	Meranti	Sugar pine
Cedar (Western Red)	Oak (American Red)	Tasmanian Oak
Cedar	Oak (European)	Tola branca
Cherry	Oak (Japanese)	Walnut
Chestnut (cultivated)	Okan	Willow
Elm	Okoumé	
Fir	Oregon pine	
Framiré	Parana pine	
Hemlock	Pear	

not recommended:

board materials, glued-up wood,
extremely abrasive or resinified woods

Afzelia (dry)	Mukulungu
Azobé	Muninga
Balau	Oak American white
Beech (dry)	Ogea
Boxwood	Padouk
Bubinga	Panga Panga
Hickory	Purpleheart
Hornbeam	Red kabbes
Keruing	Rosewood Rio
Lignum vitae	Saligna gum
Maple American	Tali
Merbau	Teak
Movingui	Wengé

Fig.: Application recommendations for both TIGRALLOY grades.

DE TECHNISCHE DATEN UND ANWENDUNGSEMPFEHLUNGEN

(Weitere Informationen finden Sie in unserer TIGRALLOY Broschüre und unserem technischen Ratgeber "Hartmetall für Schneidwerkzeuge")

TIGRALLOY, eine Legierung hauptsächlich aus Kobalt, Chrom und Wolfram, nimmt eine Sonderstellung in den Schneidstoffen ein, ist sie doch weder Hartmetall noch HSS.

Trotz der geringen Härte erreicht TIGRALLOY in vielen Anwendungen deutlich bessere Standwege als Hartmetall. Dies liegt an einem komplett anderen Verschleißverhalten, welches durch die Zusammensetzung erreicht wird. Zudem ist TIGRALLOY extrem korrosionsbeständig, bruchfest und bis 800°C hitzebeständig. Die hohe Biegebruchfestigkeit und die Materialzusammensetzung erlauben spitze Winkel und sehr scharfe Schneidkanten, was den Schnittdruck verringert und häufig eine herausragende Oberflächenqualität erzielt. TIGRALLOY wird pulvermetallurgisch hergestellt und ist deshalb, im Gegensatz zu gegossenen, ähnlichen Materialien, 100% frei von Makroporen (vgl. Abb. 1).



Abb. 1: Homogenes, makroporenfrees TIGRALLOY aus pulvermetallurgischer Herstellung im Vergleich mit ähnlich legiertem, aber gegossenem Produkt

2 Sorten sind im Angebot:

TL48 (Härte 48 HRC), insbesondere als Sägezähne in der Rohholzbearbeitung. Hier wird die Zähigkeit voll ausgenutzt, was TL48 zum idealen Schneidstoff für Kreis-, Blockband- und Gattersägen in der Sägewerksindustrie macht. Verfügbar als Dreiecke, Rechtecke und in typischen HM-Zahngeometrien.

TL60 (Härte 60 HRC) für Wendeplatten, Blanketts zum Profilieren, Hobelmesser, rückenverzahnte Messer und Lötplatten: perfekte Oberflächengüten und sehr gute Standwege in den beschriebenen Holzsorten (ohne Hartleimfugen). Zudem erreichen Sie eine Gewichtsersparnis der Schneiden um circa 40%.

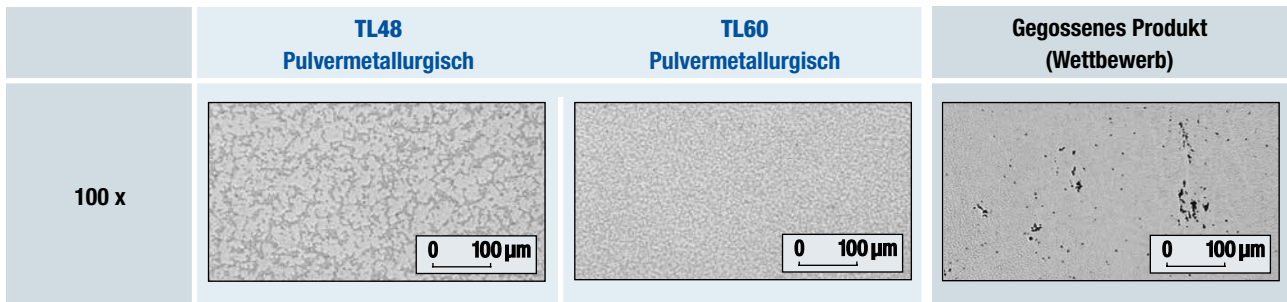
TIGRALLOY bietet entscheidende Vorteile in den meisten Massivhölzern:

- **Werkzeuglebensdauer:** In vielen Holzarten ist die Werkzeuglebensdauer im Vergleich zu Wolframkarbid, insbesondere bei Hartholz, deutlich erhöht.
- Ausgezeichnete **Oberflächenqualität:** Die hohe Biegefestigkeit und die Zusammensetzung des Materials erlauben sehr scharfe Schneidkanten, die den Schnittdruck reduzieren.
- Erhöhte **Produktivität,** da TIGRALLOY es ermöglicht, in größeren Vorschüben und Drehzahlen zu laufen.
- **Sichere Verarbeitung:** TIGRALLOY erfordert, 100% frei von Makroporen zu sein, also keine Mehrfachproduktion durch Porosität.

TL48 - für Kreissägen und Bandsägen

empfohlen:

nahezu alle Arten von Rohholz, gefrorene Hölzer
Recycling von Holz mit Eisen (z.B. Paletten)

nicht empfohlen:

Verleimhölzer, Plattenmaterial
Extrem abrasive Tropenhölzer

TL60 - zum Hobeln, für gelötete und auswechselbare Profilwerkzeuge

empfohlen:

Abachi	Framiré	Ramin
Afromosia	Hemlock	Redwood
Afzelia (min. 12% Feuchte)	Kastanie (edel)	Sapelli
Ahorn	Kiefer	Sipo
Avodire	Kirschbaum	Sugar pine
Birke (europäisch)	Lärche	Tanne
Birnbaum	Limba	Tasmanian Oak
Bleistiftzeder (kalifornisch)	Macoré	Tola
Brasilkiefer	Mahagonie	Ulme
Buche (min. 12% Feuchte)	Mengkulang	Weide
Douglasie (amerikanisch)	Meranti	Zeder (Western Red)
Eiche (europäisch)	Nussbaum	Zeder
Eiche (japanisch)	Okan	
Eiche (rot)	Okoumé	
Erle	Pappel	
Esche	Platane	

nicht empfohlen:

Verleimhölzer, Verleimholz, Extrem abrasive Tropenhölzer	
Afzelia (trocken)	Merbau
Ahorn (amerikanisch)	Movingui
Amarant	Mukulungu
Azobé	Muninga
Balau	Padouk
Bubinga	Palisander (Rio)
Buche (trocken)	Panga Panga
Buche (weiß)	Pockholz
Buchsbaum	Sidney blue gum
Daniella	Sucupira
Eiche (amerikanische Weißeiche)	Tali
Hickory	Teak
Keruing	Wengé

Fig.: Anwendungsempfehlungen für die beiden TIGRALLOY-Sorten

EN TIGRALLOY - Saw tips
 DE TIGRALLOY - Sägezähne
 FR TIGRALLOY - Dents de scie
 IT TIGRALLOY - Dentelli per lame
 ES TIGRALLOY - Dientes de sierra

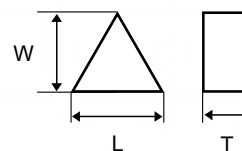

Triangles 60°

60T.180	L		W		T/Kerf		TL48
	inch	mm	inch	mm	inch	mm	
.084	0.18	4.572	0.156	4.0	0.084	2.1	139103
.103	0.18	4.572	0.156	4.0	0.103	2.6	139102
.105	0.18	4.572	0.156	4.0	0.105	2.7	139101
.110	0.18	4.572	0.156	4.0	0.110	2.8	138577
.120	0.18	4.572	0.156	4.0	0.120	3.0	138582
.130	0.18	4.572	0.156	4.0	0.130	3.3	138583
.140	0.18	4.572	0.156	4.0	0.140	3.6	138584
.150	0.18	4.572	0.156	4.0	0.150	3.8	138585
.160	0.18	4.572	0.156	4.0	0.160	4.1	138586
.170	0.18	4.572	0.156	4.0	0.170	4.3	138588
.180	0.18	4.572	0.156	4.0	0.180	4.6	141545
.190	0.18	4.572	0.156	4.0	0.190	4.8	141546

60T.250	L		W		T/Kerf		TL48
	inch	mm	inch	mm	inch	mm	
.110	0.25	6.35	0.217	5.5	0.110	2.8	132644
.120	0.25	6.35	0.217	5.5	0.120	3.0	132645
.130	0.25	6.35	0.217	5.5	0.130	3.3	132646
.140	0.25	6.35	0.217	5.5	0.140	3.6	132647
.150	0.25	6.35	0.217	5.5	0.150	3.8	132648
.160	0.25	6.35	0.217	5.5	0.160	4.1	132649
.170	0.25	6.35	0.217	5.5	0.170	4.3	132650
.180	0.25	6.35	0.217	5.5	0.180	4.6	132651
.190	0.25	6.35	0.217	5.5	0.190	4.8	132652
.200	0.25	6.35	0.217	5.5	0.200	5.1	132653
.210	0.25	6.35	0.217	5.5	0.210	5.3	132654
.220	0.25	6.35	0.217	5.5	0.220	5.6	132655
.230	0.25	6.35	0.217	5.5	0.230	5.8	132656
.240	0.25	6.35	0.217	5.5	0.240	6.1	132657
.250	0.25	6.35	0.217	5.5	0.250	6.4	132658
.260	0.25	6.35	0.217	5.5	0.260	6.6	132659
.270	0.25	6.35	0.217	5.5	0.270	6.9	132660
.280	0.25	6.35	0.217	5.5	0.280	7.1	132661

EN We supply all kinds of TIGRALLOY saw tips. Just give us dimensions and quantities.
 DE Wir liefern alle Arten von TIGRALLOY Sägezähne. Bitte geben Sie uns nur Abmessungen und Mengen an.
 FR Nous fournissons toutes sortes de dents de scie TIGRALLOY. Il suffit de nous donner des dimensions et des quantités s'il vous plaît.
 IT Forniamo tutti i tipi di TIGRALLOY inoltre ha visto punte. Per favore basta darci le dimensioni e le quantità soddisfanno.
 ES Suministramos todo tipo de TIGRALLOY vieron consejos. Sólo nos dan las dimensiones y cantidades por favor.

- EN TIGRALLOY - Saw tips
- DE TIGRALLOY - Sägezähne
- FR TIGRALLOY - Dents de scie
- IT TIGRALLOY - Dentelli per lame
- ES TIGRALLOY - Dientes de sierra

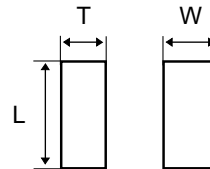

inch

Rectangles

L		T		W		TL48
inch	mm	inch	mm	inch	mm	
0.18	4.57	0.090	2.29	0.125	3.18	141186
0.18	4.57	0.090	2.29	0.150	3.81	141187
0.205	5.21	0.105	2.67	0.165	4.19	141196
0.240	6.10	0.090	2.29	0.125	3.18	141176
0.240	6.10	0.120	3.05	0.150	3.81	132670
0.240	6.10	0.120	3.05	0.175	4.45	132672
0.240	6.10	0.120	3.05	0.187	4.75	132673
0.240	6.10	0.120	3.05	0.200	5.08	132674
0.300	7.62	0.120	3.05	0.150	3.81	141208
0.300	7.62	0.120	3.05	0.187	4.75	141212
0.300	7.62	0.125	3.18	0.150	3.81	132663
0.300	7.62	0.125	3.18	0.165	4.19	132665
0.300	7.62	0.125	3.18	0.175	4.45	132666
0.300	7.62	0.125	3.18	0.187	4.750	132667
0.300	7.62	0.125	3.18	0.200	5.08	132668
0.300	7.62	0.150	3.81	0.150	3.81	141201
0.300	7.62	0.150	3.81	0.165	4.19	141203
0.300	7.62	0.150	3.81	0.225	5.72	141207
0.300	7.62	0.150	3.81	0.250	6.35	141586

EN TIGRALLOY - Saw tips
 DE TIGRALLOY - Sägezähne
 FR TIGRALLOY - Dents de scie
 IT TIGRALLOY - Dentelli per lame
 ES TIGRALLOY - Dientes de sierra

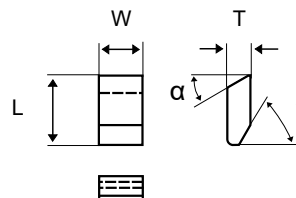

inch

CWF	L		T		W/Kerf		TL48
	inch	mm	inch	mm	inch	mm	
.100	0.5	12.7	0.125	3.2	0.100	2.5	137175
.110	0.5	12.7	0.125	3.2	0.110	2.8	137176
.120	0.5	12.7	0.125	3.2	0.120	3.1	135859
.130	0.5	12.7	0.125	3.2	0.130	3.3	135860
.140	0.5	12.7	0.125	3.2	0.140	3.6	135861
.150	0.5	12.7	0.125	3.2	0.150	3.8	135862
.160	0.5	12.7	0.125	3.2	0.160	4.1	137177
.165	0.5	12.7	0.125	3.2	0.165	4.2	135863
.170	0.5	12.7	0.125	3.2	0.170	4.3	135864
.180	0.5	12.7	0.125	3.2	0.180	4.6	137178
.190	0.5	12.7	0.125	3.2	0.190	4.8	137179
.200	0.5	12.7	0.125	3.2	0.200	5.1	137180
.210	0.5	12.7	0.125	3.2	0.210	5.3	137181
.220	0.5	12.7	0.125	3.2	0.220	5.6	137182
.230	0.5	12.7	0.125	3.2	0.230	5.8	137183
.240	0.5	12.7	0.125	3.2	0.240	6.1	137184
.250	0.5	12.7	0.125	3.2	0.250	6.4	137185
.437	0.5	12.7	0.125	3.2	0.437	11.1	139104
.500	0.5	12.7	0.125	3.2	0.500	12.7	139105

metric

8.5 x 2.5	L	T	W/Kerf	TL48
	mm	mm	mm	
	8.5	2.5	2.4	137420
	8.5	2.5	2.6	138684
	8.5	2.5	2.8	137602
	8.5	2.5	3.0	138688
	8.5	2.5	3.2	138707
	8.5	2.5	3.4	138709

11 x 4	L	T	W/Kerf	TL48
	mm	mm	mm	
	11.0	4.0	4.0	137197
	11.0	4.0	4.5	137198
	11.0	4.0	5.0	136535
	11.0	4.0	5.5	137199
	11.0	4.0	6.0	137200
	11.0	4.0	6.5	137201

EN We supply all kinds of TIGRALLOY saw tips. Just give us dimensions and quantities.
 DE Wir liefern alle Arten von TIGRALLOY Sägezähne. Bitte geben Sie uns nur Abmessungen und Mengen an.
 FR Nous fournissons toutes sortes de dents de scie TIGRALLOY. Il suffit de nous donner des dimensions et des quantités s'il vous plaît.
 IT Forniamo tutti i tipi di TIGRALLOY inoltre ha visto punte. Per favore basta darci le dimensioni e le quantità soddisfanno.
 ES Suministramos todo tipo de TIGRALLOY vieron consejos. Sólo nos dan las dimensiones y cantidades por favor.

- EN TIGRALLOY - Blanks for profiling
- DE TIGRALLOY - Blanketts zum Profilieren
- FR TIGRALLOY - Plaquettes à profiler
- IT TIGRALLOY - Placchette da profilare
- ES TIGRALLOY - Placas para perfilar

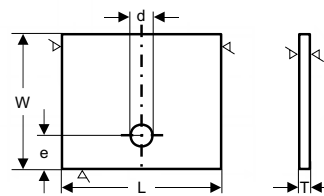

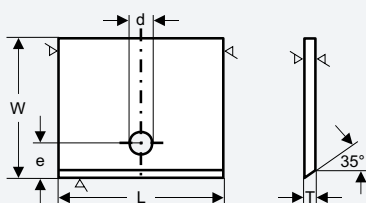
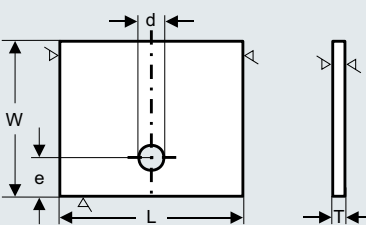
	L	W	T	d		e	TL60
	mm	mm	mm	mm		mm	
	15.0	20.4	2.0	4.1		6.3	050254
	15.0	25.4	2.0	4.1		6.3	062363
	15.0	30.4	2.0	4.1		6.3	050432
	20.0	20.4	2.0	4.1		6.3	050433
	20.0	25.4	2.0	4.1		6.3	050434
	20.0	30.4	2.0	4.1		6.3	050435
	25.0	20.4	2.0	4.1		6.3	061898
	25.0	25.4	2.0	4.1		6.3	050437
	25.0	30.4	2.0	4.1		6.3	050438
	30.0	25.4	2.0	4.1		6.3	062030
	30.0	30.4	2.0	4.1		6.3	061982
	30.0	35.4	2.0	4.1		6.3	062039
	35.0	30.4	2.0	4.1		6.3	061960
	35.0	35.4	2.0	4.1		6.3	050443
		20.0	20.4	2.0	4.5		6.5
20.0		25.4	2.0	4.5		6.5	050444
20.0		30.4	2.0	4.5		6.5	062217
25.0		25.4	2.0	4.5		6.5	050446
25.0		30.4	2.0	4.5		6.5	050447
30.0		30.4	2.0	4.5		6.5	050448

EN TIGRALLOY - Blanks for profiling
 DE TIGRALLOY - Blanketts zum Profilieren
 FR TIGRALLOY - Plaquettes à profiler
 IT TIGRALLOY - Placchette da profilare
 ES TIGRALLOY - Placas para perfilar

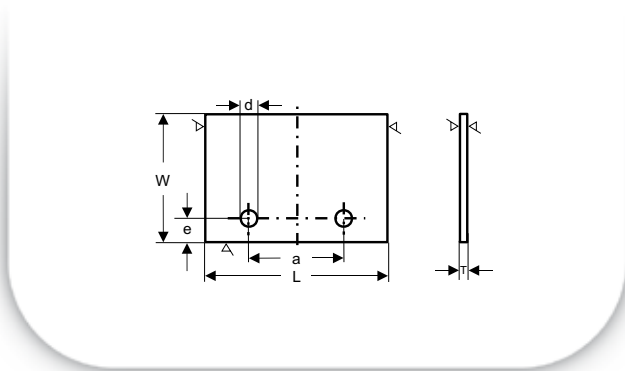

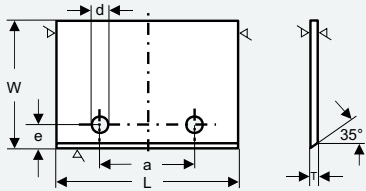
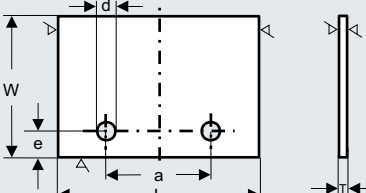
	L	W	T	d	a	e	TL60
	mm	mm	mm	mm	mm	mm	
	30.0	25.4	2.0	4.1	14.0	6.3	050256
	30.0	30.4	2.0	4.1	14.0	6.3	062258
	30.0	35.4	2.0	4.1	14.0	6.3	062101
	40.0	25.4	2.0	4.1	26.0	5.5	062124
	40.0	30.0	2.0	4.1	20.0	5.5	046483
	40.0	35.0	2.0	4.1	26.0	5.5	046485
	40.0	35.4	2.0	4.1	26.0	6.0	062075
	40.0	35.4	2.0	4.1	26.0	6.3	050453
	40.0	40.4	2.0	4.1	26.0	6.0	062117
	40.0	45.4	2.0	4.1	26.0	6.0	062083
	50.0	20.0	2.0	4.1	26.0	5.5	050457
	50.0	25.4	2.0	4.1	26.0	5.5	062064
	60.0	25.4	2.0	4.1	26.0	5.5	050459
	60.0	35.4	2.0	4.1	44.0	6.0	062289
	60.0	40.0	2.0	4.1	44.0	6.0	046487
	30.0	30.4	3.0	4.1	14.0	6.5	105787
	30.0	35.4	3.0	4.1	14.0	6.5	106190
	40.0	30.0	3.0	4.1	20.0	5.5	046484
	30.0	20.4	2.0	4.1	14.0	6.5	050257
	30.0	25.4	2.0	4.1	19.0	4.75	062063
	30.0	25.4	2.0	4.1	14.0	6.5	050464
	30.0	30.4	2.0	4.1	14.0	6.5	050465
	30.0	30.0	2.0	4.1	19.0	4.75	062278
	35.0	25.4	2.0	4.1	14.0	6.5	050467
	35.0	30.4	2.0	4.1	14.0	6.5	062274
	40.0	20.4	2.0	4.1	26.0	6.5	062105
	40.0	25.4	2.0	4.1	26.0	6.5	047452
	40.0	30.4	2.0	4.1	26.0	6.5	050470
	40.0	35.4	2.0	4.1	26.0	5.5	050471
	50.0	20.4	2.0	4.1	26.0	6.5	050472
	50.0	25.4	2.0	4.1	26.0	6.5	050473
	50.0	30.4	2.0	6.0	26.0	6.5	047593
	60.0	20.4	2.0	4.1	26.0	6.5	050474
	60.0	25.4	2.0	4.1	26.0	6.5	050475
	60.0	30.4	2.0	4.1	26.0	6.5	050476

- EN TIGRALLOY - Blanks for profiling
- DE TIGRALLOY - Blanketts zum Profilieren
- FR TIGRALLOY - Plaquettes à profiler
- IT TIGRALLOY - Placchette da profilare
- ES TIGRALLOY - Placas para perfilar

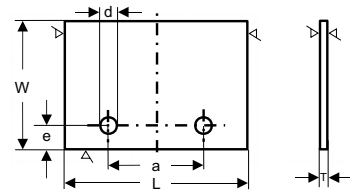

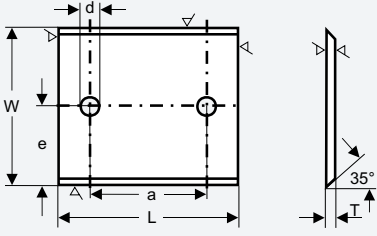

	L	W	T	d	a		TL60
	mm	mm	mm	mm	mm		
	40.0	25.0	2.0	4.1	20.0		050258
	40.0	30.0	2.0	3.5	20.0		050477
	40.0	30.0	2.0	4.1	20.0		050478
	40.0	35.0	2.0	4.1	26.0		047372
	40.0	40.0	2.0	3.5	26.0		050479
	45.0	35.0	2.0	4.1	26.0		046971
	50.0	25.0	2.0	4.1	26.0		050481
	50.0	45.0	2.0	4.1	34.0		050482
	60.0	35.0	2.0	4.1	26.0		046520
	60.0	35.0	2.0	4.1	44.0		047030

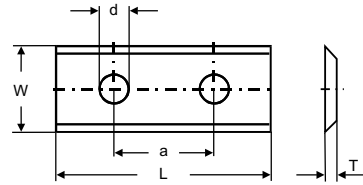
- EN TIGRALLOY - Indexable knives
- DE TIGRALLOY - Wendeschneidplatten
- FR TIGRALLOY - Plaquettes réversibles
- IT TIGRALLOY - Coltelli reversibili
- ES TIGRALLOY - Cuchillas reversibles

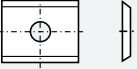
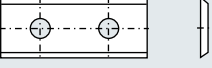

35° + 45°

	L mm	W mm	T mm	a mm		TL60
	20.0	12.0	1.5		35°	131213
	30.0	12.0	1.5	14.0	35°	131229
	50.0	12.0	1.5	26.0	35°	131238
	50.0	12.0	1.5	26.0	45°	135985
	60.0	12.0	1.5	26.0	35°	131239
	60.0	12.0	1.5	26.0	45°	136018
	80.0	13.0	2.2	60.0	35°	131242
	80.0	13.0	2.2	60.0	45°	138569
	100.0	13.0	2.2	60.0	35°	131246
	100.0	13.0	2.2	60.0	45°	138572
	120.0	13.0	2.2	60.0	35°	131248
	120.0	13.0	2.2	60.0	45°	138575

- EN TIGRALLOY - Indexable knives
- DE TIGRALLOY - Wendeschneidplatten
- FR TIGRALLOY - Plaquettes réversibles
- IT TIGRALLOY - Coltelli reversibili
- ES TIGRALLOY - Cuchillas reversibles

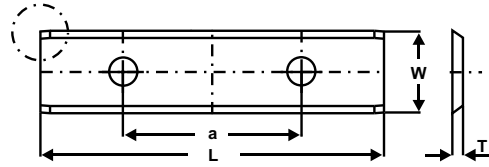

For use in planer heads

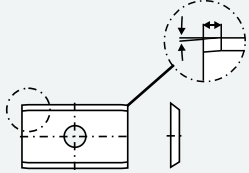
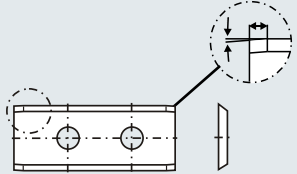
	L mm	W mm	T mm		TL60
	20.0	12.0	1.5	35°	138286
	30.0	12.0	1.5	35°	138174

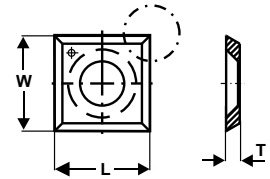

For use in planer heads

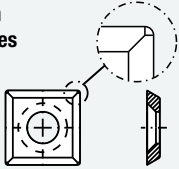
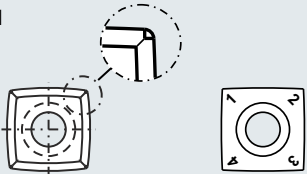
	L mm	W mm	T mm		TL60
Straight with rounded edges 	15.0	15.0	2.5	30°	138360
	15.0	15.0	2.5	37°	138683
Cutting edge with radius and rounded edges 	15.0	15.0	2.5	R=50	138686
	15.0	15.0	2.5	R=150	132918

- EN TIGRALLOY - Strips for brazed cutters
- DE TIGRALLOY - Fräserplatten zum Löten
- FR TIGRALLOY - Plaquettes à braser
- IT TIGRALLOY - Placchette per frese saldobrasate
- ES TIGRALLOY - Placas para equipar fresas

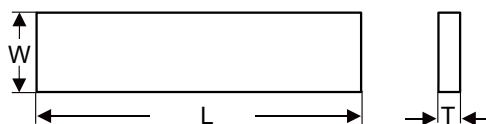

Strips metric

L mm	W mm	T mm	TL60
165	10	3	050137
165	12	3	050138
165	15	3	050185
165	16	3	050186
165	18	3	050187
165	20	3	050188
165	25	3	050189
165	10	4	050190
165	12	4	050191
165	15	4	050192
165	16	4	050193
165	18	4	050194
165	20	4	050195
165	25	4	050196
165	30	4	050197
165	10	5	050199
165	12	5	050200
165	15	5	050201
165	16	5	050202
165	18	5	050203
165	20	5	050204
165	25	5	050205
165	30	5	050206
165	35	5	050207
165	40	5	050209
165	20	8	102187
165	25	8	119946
165	30	8	138563
165	35	8	102188

- EN TIGRALLOY - Strips for brazed cutters
- DE TIGRALLOY - Fräserplatten zum Löten
- FR TIGRALLOY - Plaquettes à braser
- IT TIGRALLOY - Placchette per frese saldobrasate
- ES TIGRALLOY - Placas para equipar fresas

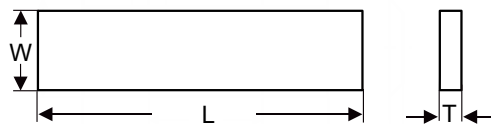

STBs inch

L		W		T		TL60
inch	mm	inch	mm	inch	mm	
6	152,4	3/8	9,5	3/32	2,38	046284
6	152,4	1/2	12,7	3/32	2,38	046290
6	152,4	5/8	15,88	3/32	2,38	046291
6	152,4	3/4	19,0	3/32	2,38	046292
6	152,4	7/8	22,23	3/32	2,38	046293
6	152,4	1	25,4	3/32	2,38	046294
6	152,4	1 1/8	28,58	3/32	2,38	046352
6	152,4	1 1/4	31,75	3/32	2,38	046353
6	152,4	1 1/2	38,1	3/32	2,38	046354
6	152,4	3/8	9,53	1/8	3,18	046295
6	152,4	1/2	12,7	1/8	3,18	046296
6	152,4	5/8	15,88	1/8	3,18	046297
6	152,4	3/4	19,05	1/8	3,18	046298
6	152,4	7/8	22,23	1/8	3,18	046299
6	152,4	1	25,4	1/8	3,18	046300
6	152,4	1 1/8	28,58	1/8	3,18	046454
6	152,4	1 1/4	31,75	1/8	3,18	046301
6	152,4	1 1/2	38,1	1/8	3,18	046302
6	152,4	3/8	9,53	5/32	3,97	046459
6	152,4	1/2	12,7	5/32	3,97	046460
6	152,4	5/8	15,88	5/32	3,97	046461
6	152,4	3/4	19,05	5/32	3,97	046462
6	152,4	7/8	22,23	5/32	3,97	046463
6	152,4	1	25,4	5/32	3,97	046464
6	152,4	1 1/8	28,58	5/32	3,97	046465
6	152,4	1 1/4	31,75	5/32	3,97	046466
6	152,4	1 1/2	38,1	5/32	3,97	046467
6	152,4	3/8	152,4	3/16	4,76	046469
6	152,4	1/2	152,4	3/16	4,76	046470
6	152,4	5/8	152,4	3/16	4,76	046471
6	152,4	3/4	152,4	3/16	4,76	046472
6	152,4	7/8	152,4	3/16	4,76	046473
6	152,4	1	152,4	3/16	4,76	050603
6	152,4	1 1/8	152,4	3/16	4,76	046474
6	152,4	1 1/4	152,4	3/16	4,76	046475
6	152,4	1 1/2	152,4	3/16	4,76	046476

- EN TIGRALLOY - Preformed tips for brazed cutters
- DE TIGRALLOY - Formplatten zum Löten
- FR TIGRALLOY - Plaquettes à braser
- IT TIGRALLOY - Placchette per frese saldobrasate
- ES TIGRALLOY - Placas para herramientas soldadas

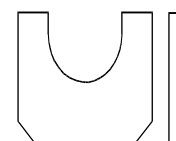

EN Using preformed tips for your brazed cutters you will save the expensive roughing time and grinding wheel cost. TIGRA can supply almost any kind of preformed tip according to the customer's drawing or DXF file.

DE Mit Formteilen für Ihre gelöteten Fräser sparen Sie teure Schruppzeit und Schleifscheibekosten. TIGRA kann fast jede Art von Formteilen nach Zeichnung des Kunden oder einer DXF-Datei liefern.

FR En utilisant des plaquettes à braser préformées pour vos coupeurs brasés, vous économiserez le coût coûteux et le coût de la meule. TIGRA peut fournir presque n'importe quel type de plaquettes à braser préformées selon le dessin du client ou le fichier DXF.

IT Usando le punte preformati per le frese brasate vi farà risparmiare il tempo di sgrossatura costoso e rettifica dei costi ruota. TIGRA in grado di fornire qualsiasi tipo di punta preformata secondo le dei customer disegno o file DXF.

ES Usando las puntas preformadas para sus cortadoras soldadas usted ahorrará el costoso tiempo de desbaste y el costo de la muela abrasiva. TIGRA puede suministrar casi cualquier tipo de punta preformada según el dibujo del cliente o el archivo DXF.

- EN TIGRALLOY - Planer knives
- DE TIGRALLOY - Hobelmesser
- FR TIGRALLOY - Couteaux à raboter
- IT TIGRALLOY - Coltelli da pialla
- ES TIGRALLOY - Cuchillas para cepillar

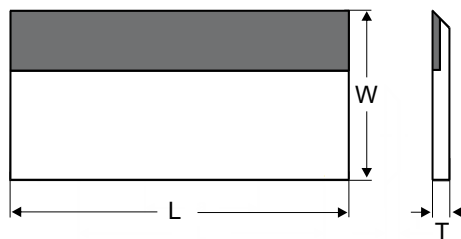

EN TIGRALLOY-tipped thin planer knives
 DE TIGRALLOY-bestückte Streifenhobelmesser
 FR Couteaux à mise rapportée TIGRALLOY
 IT Coltelli da pialla con TIGRALLOY riportato
 ES Cuchillas con TIGRALLOY

L	T	W = 25 mm	W = 30 mm	W = 35 mm
mm	mm			
60	3.0	138564	138647	139049
80	3.0	138566	138655	139050
100	3.0	138567	138658	139053
110	3.0	138568	139040	139054
120	3.0	138571	139041	139055
130	3.0	138573	139042	139056
150	3.0	138579	139043	139057
160	3.0	138581	139044	139058
170	3.0	138611	139045	139059
180	3.0	138613	139046	139060
200	3.0	138616	139047	139061
210	3.0	138619	139048	139062
230	3.0	138677	103033	139106
240	3.0	138679	138703	139107
250	3.0	138681	138704	139108
260	3.0	138682	138705	139109
270	3.0	138691	138706	139110
300	3.0	138432	138428	138431
310*	3.0	138692	138708	139111
330	3.0	138693	138710	139112
350	3.0	138694	138711	139113
400	3.0	138695	138712	139114
410	3.0	138697	138713	139115
500	3.0	138699	138714	139116
510	3.0	138701	138715	139117
520	3.0	138739	139076	139089
530	3.0	139063	139077	139090
600	3.0	139064	139078	139091
610	3.0	139065	139080	139092
630	3.0	139066	139081	139093
640	3.0	139067	139082	139094
680	3.0	139070	139083	139095
710	3.0	139071	139084	139096
810	3.0	139072	139085	139097
820	3.0	139073	139086	139098
1010	3.0	139074	139087	139099
1050	3.0	139075	139088	139100

* EN If longer than 300mm, TIGRALLOY is brazed in segments.
 * DE Wenn länger als 300mm ist, wird TIGRALLOY in Segmenten gelötet.
 * FR Si plus long de 300 mm, TIGRALLOY est brasé en segments.
 * IT Se più lungo di 300 mm, TIGRALLOY è brasato in segmenti.
 * ES Si es más largo de 300mm, TIGRALLOY está soldado en segmentos.

- EN TIGRALLOY - System Planer knives
 DE TIGRALLOY - Systemhobelmesser
 FR TIGRALLOY - Couteaux à raboter pour système
 IT TIGRALLOY - Coltelli da pialla per sistema
 ES TIGRALLOY - Cuchillas para cepillar para sistema

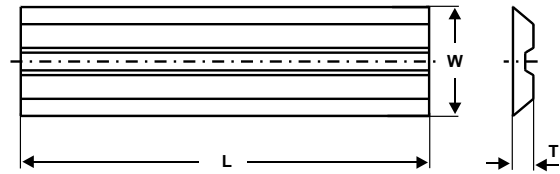

For System Centrolock*

L mm	W mm	T mm	TL60
100.0	16.0	3.0	138644
130.0	16.0	3.0	138598
150.0	16.0	3.0	138596
170.0	16.0	3.0	138594
230.0	16.0	3.0	138587
240.0	16.0	3.0	138578

* EN For use in Centrolock-cutterheads only.
 * DE Nur zur Verwendung in Centrolock-Messerköpfen.
 * FR Utilisation limitée aux porte outils de Centrolock.
 * IT Da usare solo su teste portacoltelli della Centrolock.
 * ES Sólo para empleo con portacuchillas de Centrolock.

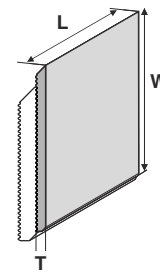

EN TIGRALLOY blank with corrugated steel backing plate
 DE TIGRALLOY-Blankett mit rückenverzahnter Stahlstützplatte
 FR Plaquette TIGRALLOY avec porte-plaquette denté en acier
 IT Coltello in TIGRALLOY zigrinato con piastra di supporto zigrinata in acciaio
 ES Cuchilla de TIGRALLOY con placa de soporte dentada por el lomo en el acero

EN TIGRALLOY - SuperPac
 DE TIGRALLOY - SuperPac
 FR TIGRALLOY - SuperPac
 IT TIGRALLOY - SuperPac
 ES TIGRALLOY - SuperPac

L mm	W mm	T mm	TL60	L mm	W mm	T mm	Steel backing plate
40	38	3.2	136986	40	35	7.1	024090
50	38	3.2	138592	50	35	7.1	043957
60	38	3.2	136987	60	35	7.1	024123
80	38	3.2	136988	80	35	7.1	024156
100	38	3.2	138600	100	35	7.1	023957
120	38	3.2	138601	120	35	7.1	023990
130	38	3.2	138602	130	35	7.1	024024
150	38	3.2	138603	150	35	7.1	024057
170	38	3.2	136985	170	35	7.1	045837
180	38	3.2	138604	180	35	7.1	113484
200	38	3.2	138605	200	35	7.1	113485
210	38	3.2	138607	210	35	7.1	113486
230	38	3.2	138608	230	35	7.1	113487
310	38	3.2	138609	310	35	7.1	112229
40	50	3.2	136989	40	47	7.1	024101
50	50	3.2	138612	50	47	7.1	043958
60	50	3.2	136990	60	47	7.1	024134
80	50	3.2	136991	80	47	7.1	024167
100	50	3.2	138615	100	47	7.1	023968
120	50	3.2	138618	120	47	7.1	024001
130	50	3.2	138620	130	47	7.1	024035
150	50	3.2	138621	150	47	7.1	024068
170	50	3.2	136984	170	47	7.1	045838
180	50	3.2	138624	180	47	7.1	113488
200	50	3.2	138625	200	47	7.1	113489
210	50	3.2	138627	210	47	7.1	113490
230	50	3.2	138629	230	47	7.1	113491
310	50	3.2	138631	310	47	7.1	112230
40	60	3.2	136992	40	57	7.1	024112
50	60	3.2	138633	50	57	7.1	043959
60	60	3.2	136993	60	57	7.1	024145
80	60	3.2	136994	80	57	7.1	024178
100	60	3.2	138635	100	57	7.1	023979
120	60	3.2	138637	120	57	7.1	024012
130	60	3.2	138638	130	57	7.1	024046
150	60	3.2	138640	150	57	7.1	024079
170	60	3.2	135349	170	57	7.1	045839

EN TIGRALLOY - SuperPac
 DE TIGRALLOY - SuperPac
 FR TIGRALLOY - SuperPac
 IT TIGRALLOY - SuperPac
 ES TIGRALLOY - SuperPac

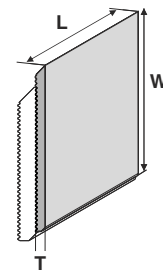

EN TIGRALLOY blank with corrugated steel backing plate
 DE TIGRALLOY-Blankett mit rückenverzahnter Stahlstützplatte
 FR Plaquette TIGRALLOY avec porte-plaquette denté en acier
 IT Coltello in TIGRALLOY zigrinato con piastra di supporto zigrinata in acciaio
 ES Cuchilla de TIGRALLOY con placa de soporte dentada por el lomo en el acero

	EN Security advices DE Sicherheitshinweise FR Conseils de sécurité	IT Consigli di sicurezza ES Consejo de seguridad								
<p>$s = 3,2 \text{ mm}$</p>	<p>EN Cutting Edge Projection Between carbide blank and backing plate $s=3,2 \text{ mm}$ (critical dimension when regrinding).</p> <p>DE Schneidenüberstand Schneidenüberstand von Hartmetallplatte zu Stützplatte $s=3,2 \text{ mm}$ (beim Nachschärfen zu beachten).</p> <p>FR Saillie des plaquettes Les plaquettes carbure dépassent le support de $3,2 \text{ mm}$ (à prendre en compte lors du réaffûtage).</p> <p>IT Sporgenza del tagliente Sporgenza del tagliente rispetto alla piastrina di supporto $s= 3,2 \text{ mm}$ (prestare attenzione in caso di riaffilatura).</p> <p>ES Exceso de corte El exceso de corte desde la placa de metal duro hacia la placa de soporte es $e=3,2 \text{ mm}$ (obsérvelo cuando se reafila).</p>									
	<p>EN Maximum Profile Depth</p> <p>DE Maximale Profiltiefe</p> <p>FR Profondeur de profil maximum</p> <p>IT Profondità massima della sagomatura</p> <p>ES Profundidad máxima de perfil</p>	<table border="1"> <thead> <tr> <th>W mm</th> <th>P max mm</th> </tr> </thead> <tbody> <tr> <td>38</td> <td>-</td> </tr> <tr> <td>50</td> <td>12</td> </tr> <tr> <td>60</td> <td>23</td> </tr> </tbody> </table>	W mm	P max mm	38	-	50	12	60	23
W mm	P max mm									
38	-									
50	12									
60	23									
<p>DANGER</p>	<p>EN Warning! Specifically positioning of blank and backing plate; be aware of the safety regulations!</p> <p>DE Warnung! Sitzgenauer Einbau von Blankett und Stützplatte; Sicherheitsbestimmungen beachten!</p> <p>FR Avertissement! Positionnement précis de plaque et porte-plaquette; observez les règles de sécurité!</p> <p>IT Attenzione! Esatto montaggio in sede del coltello e della piastrina di supporto; rispettare le norme di sicurezza!</p> <p>ES Aviso! Específicamente el posicionamiento de la placa en blanco y el apoyo, estar al tanto de las normas de seguridad!</p>									
<p>DANGER</p>	<p>EN Warning! Maximum adjustment of blank = 8 mm</p> <p>DE Warnung! Maximale Verstellung des Blanketts = 8 mm</p> <p>FR Avertissement! Ajustement maximum de plaquette = 8 mm</p> <p>IT Attenzione! Regolazione massima della placchetta = 8 mm</p> <p>ES Aviso! El ajuste máximo del espacio en placa = 8 mm</p>									